

#2024133220 (RLY)
#2024133255 (REG)

#2024133218 (BPUP)
#2024133219 (NATL)

#20241332(O)
#2024133256 (SWPC)

JUDGING PROGRAM

Regional & National Specialty Shows
Puppy & Veteran Sweepstakes, Obedience, Rally, Junior Showmanship
4-6 Mos Beginner Puppy Attraction
(Unbenched)(All Judging Indoors)
Show Hours 8:00 AM to 6:00 PM Each Day

TUESDAY - FRIDAY
April 30 - May 3, 2024



ENGLISH COCKER SPANIEL CLUB OF AMERICA, INC.

(Member of the American Kennel Club)

Crowne Plaza Asheville
One Resort Drive
Asheville, NC

Tuesday, April 30 - Obedience, Rally & Regional Specialty

Wednesday - Friday, May 1-3 - Sweepstakes, Junior Showmanship,
4-6 Mos Beginner Puppy & National Specialty

This National is dedicated to the memory of
Betty Ganung, Sheila Eckstein, Si Moss,
Kate Romanski & Kay Sutter

	<p>Services and Equipment Furnished by <i>Rau Dog Shows, Ltd.</i> P.O. Box 6998 Reading, PA 19610 (610) 376-1880 email: info@raudogshows.com www.raudogshows.com <i>Overnight and Express Deliveries</i> 235 South Second Avenue, West Reading, PA 19611 American Kennel Club Annually Licensed Superintendents</p> <table><tr><td>Kathy Berkheimer</td><td>Kristie Zimmerman</td><td>Kathy Hague</td></tr><tr><td>Ed Smizer</td><td>Kitty Burke</td><td>Al Staudt, Jr.</td></tr><tr><td>Rayanne Lehman</td><td>Daemon Heckman</td><td>Dennis Lehman</td></tr><tr><td>Dustin Bates</td><td></td><td>Wayne Hallard</td></tr></table>	Kathy Berkheimer	Kristie Zimmerman	Kathy Hague	Ed Smizer	Kitty Burke	Al Staudt, Jr.	Rayanne Lehman	Daemon Heckman	Dennis Lehman	Dustin Bates		Wayne Hallard
Kathy Berkheimer	Kristie Zimmerman	Kathy Hague											
Ed Smizer	Kitty Burke	Al Staudt, Jr.											
Rayanne Lehman	Daemon Heckman	Dennis Lehman											
Dustin Bates		Wayne Hallard											

MONDAY, APRIL 29, 2024

RING ONE

JUDGE: Mystery Judge

6:00 PM

- 7 - Cut Down
- 1 - 6 mos- 6 Yrs Dog
- 2 - 6-10 Yrs Dogs
- 1 - 10+ Yrs Dog
- 2 - 6-10 Yrs Bitches
- 1 - 10+ Yrs Bitch

**REGIONAL SPECIALTY
TUESDAY, APRIL 30, 2024
RING ONE**

JUDGE: Mrs. Meghan Riese-Bassel

8:00 AM

- 199 - Spaniels (English Cocker)
- 10 - 6-9 mos Puppy Dogs
- 11 - 9-12 mos Puppy Dogs
- 3 - 12-18 mos Dogs
- 5 - Bred-by-Exhibitor Dogs, Puppy
- 8 - Bred-by-Exhibitor Dogs, Adult
- 5 - Open Dogs, Parti
- 3 - Open Dogs, Solid
 - Winners Dog
- 11 - 6-9 mos Puppy Bitches
- 4 - 9-12 mos Puppy Bitches
- 7 - 12-18 mos Bitches
- 1 - Amateur Owner-Handler Bitch
- 9 - Bred-by-Exhibitor Bitches, Puppy
- 13 - Bred-by-Exhibitor Bitches, Adult
- 2 - American-Bred Bitches
- 9 - Open Bitches, Parti
- 4 - Open Bitches, Solid
 - Winners Bitch
- 4 - Veteran Dogs 7-10 yrs
- 2 - Veteran Dogs, 10 yr & over
- 8 - Veteran Bitches, 7-10 yrs
- 3 - Veteran Bitches, 10 yrs & over
- 2 - Field Trial Dogs
- 1 - Field Trial Bitch
- 73 - Best of Breed Competition (41-32)

199 Total Dogs

Judge will take a luncheon break at their discretion.

There are 199 dogs with 199 entries in this show.

RING TWO - OBEDIENCE

JUDGE: Ted G McCall

8:00 AM

- 2 - Open "B" & Preferred Open P735, 201-202
- 5 - Open "A" 134-138
- 2 - Graduate Novice 501-502

9:15 AM

- 8 - Novice "B" 70-77

10:15 AM

- 3 - Preferred Novice 701-703
- 1 - Veteran 651

11:00 AM

- 8 - Beginner Novice "B" 951-958
- 1 - Beginner Novice "A" 901

31 Total Dogs

RING TWO - RALLY

JUDGE: Ted G McCall

12:45 PM

- 3 - Choice 960-962
 - 9 - Masters 900-908
 - 11 - Excellent "B" 800-810
 - 14 - Advanced "B" 600-613
 - 5 - Intermediate 300-304
 - 9 - Novice "B" 200-204, 206-209
 - 2 - Novice "A" 5-6
- 53 Total Dogs

**NATIONAL SPECIALTY
WEDNESDAY, MAY 1, 2024
RING ONE**

JUDGE: Dr. Bruce Barrett, DVM

8:00 AM

- 124 - Spaniel (English Cocker) Sweepstakes
- 104 - Puppy Sweepstakes
- 14 - 6-9 mos Puppy Dogs
- 14 - 9-12 mos Puppy Dogs
- 4 - 12-15 mos Dogs
- 7 - 15-18 mos Dogs
- 4 - 18-24 mos Dogs
- 17 - 6-9 mos Puppy Bitches
- 9 - 9-12 mos Puppy Bitches
- 9 - 12-15 mos Bitches
- 10 - 15-18 mos Bitches
- 16 - 18-24 mos Bitches
- Best in Sweepstakes
- Reserve Best in Sweepstakes
- Best of Opposite Sex to Best in Sweeps

followed by

- 20 - Veteran Sweepstakes
- 2 - Veteran Dogs, 7-9 yrs
- 4 - Veteran Dog, 9-11 yrs
- 3 - Veteran Dogs, 11 yr & over
- 6 - Veteran Bitches, 7-9 yrs
- 3 - Veteran Bitches, 9-11 yrs
- 2 - Veteran Bitches 11 yrs & over
- Best in Veteran Sweepstakes
- Reserve Best in Veteran Sweepstakes
- Best of Opposite Sex to Best in Sweeps

124 Total Dogs

Judge will take a luncheon break at their discretion

RING ONE

JUDGE: Ms. Debbie Mason

5:30 PM

- 10 - Stud Dogs
 - 9 - Brood Bitches
- 19 Total Dogs

THURSDAY, MAY 2, 2024

RING ONE

JUDGE: Joyce B Winkels

8:00 AM

- 12 - 4-6 Mos Beginner Puppy Attraction (5-7)

8:45 AM

- 155 - Spaniels (English Cocker)
- 11 - 6-9 mos Puppy Dogs
- 11 - 9-12 mos Puppy Dogs
- 4 - 12-18 mos Dogs
- 6 - Bred-by-Exhibitor Dogs, Puppy
- 10 - Bred-by-Exhibitor Dogs, Adult
- 6 - Open Dogs, Parti
- 3 - Open Dogs, Solid
 - Winners Dog

- 12 - 6-9 mos Puppy Bitches
- 4 - 9-12 mos Puppy Bitches
- 7 - 12-18 mos Bitches
- 10 - Bred-by-Exhibitor Bitches, Puppy
- 19 - Bred-by-Exhibitor Bitches, Adult
- 2 - American-Bred Bitches
- 9 - Open Bitches, Parti
- 7 - Open Bitches, Solid
 - Winners Bitch
- 7 - Veteran Dogs 7-10 yrs
- 2 - Veteran Dogs, 10 yr & over
- 10 - Veteran Bitches, 7-10 yrs
- 4 - Veteran Bitches, 10 yrs & over
- 3 - Field Trial Dogs
 - 1 - Field Trial Bitch
- 6 - Brace
- 1 - Team

167 Total Dogs

Judge will take a luncheon break at their discretion.

FRIDAY, MAY 3, 2024

RING ONE

JUDGE: Mr. Douglas Belter

8:00 AM

3 - Junior Showmanship

3 - JS Open Junior (9-12)

3 Total

Followed By

Pee Wee Junior Handler Competitor

RING ONE

Parade of Titleholders

RING ONE

JUDGE: Joyce B Winkels

9:30 AM

85 - Best of Breed Competition (46-39)

- Best Puppy

- Best Bred-by-Exhibitor

85 Total Dogs

Judge will take a luncheon break at their discretion.

There are 262 dogs with 386 entries, plus 31 Obedience, 54 Rally & 12 4-6 Mos Beg Puppy entries in this show.

EVENT CHAIR

David Sullivan
108 Edgemere Dr
Annapolis, MD 21403
davidnmd2003@yahoo.com
410-259-7925

Assistant Chair

Linda Amick
4605 Lexington Rd
Athens, GA 30605
404-325-1692

Rally Chair

Debbie Straw
249 Snapps Mill Rd
Spout Spring, VA 24593
debstraw@aol.com
425-352-5024

JUDGES

Dr. Bruce Barrett, DVM

5040 Glenview St, Chino Hills, CA 91709

Mr. Douglas Belter

6736 W Irving Rd, Hastings, MI 49058

Ted G McCall

30 Southwinds Dr, Fairview, NC 28730

Ms. Debbie Mason

881 Congress St, Duxbury, MA 02332

Mrs. Meghan Riese-Bassel

130 Quail Valley Rd, Social Circle, GA 30025

Joyce B Winkels

8635 368th Ave, Burlington, WI 53105

HOST HOTEL

Crowne Plaza Asheville
One Resort Drive, Asheville, NC 28806
(828) 254-3211

Expo Center Hours - 5:00 am - 10:00 pm

Expo Center will be available after 10:00 am Monday

VETERINARIAN

MedVet Asheville (24/7) - 677 Brevard Road, Asheville, NC 28806

Directions - Head south on Resort Dr toward Expo Dr, Turn right onto Patton Ave, Use the left lane to turn slightly left, Continue straight, Merge onto I-240 W/I-26 E, Take exit 1B for Brevard Rd/NC-191 toward I-40 E, Turn left onto NC-191 S/Brevard Rd

Exhibitors should follow their veterinarians' recommendation to assure their dogs are free of internal and external parasites, any communicable diseases, and have appropriate vaccinations.

PHOTOGRAPHER

Jeffrey Hanlin, Jr
17 Concord Drive, Irwin, PA 15642
724-244-3764

VIDEOGRAPHER

Show Dog Video Pros
40 Junction Road, South Berwick, ME 03908
showdogvideopros@gmail.com ● 888-808-0870 ●
www.showdogvideopros.com

ShowDogVideoPros will professionally video record the 2024 ECSCA National

Video Features

● Filming in Hi-Definition ● Blu-Ray Discs available ● Standard Video DVD Discs available
Single Class & Single Dog Videos available ● Every conformation dog titled with complete catalog information

LIVE STREAMING VIDEO

The video recorded each day during the show will be loaded to an online streaming video site. You will be able to watch the video re-broadcast on your own computer the next day after judging (watch Tuesday judging starting Wednesday; watch Wednesday judging starting Thursday, etc.) The complete and unedited video will remain available for viewing for 4-6 weeks after the show. There will be a nominal charge for viewing. More information at: www.showdogvideopros.com Exclusive Professional Video Contract ShowDogVideoPros has an exclusive contract for professional video services at the 2024 ECSCA National Show. No other professional video will be allowed. Professional video includes filming from any tripod mounted camera, or filming whole classes or large segments of the show. Video of handheld camera only of your dog is allowed.

DRIVING DIRECTIONS

FROM THE EAST (Hickory, Winston-Salem, Greensboro, etc.): Travel West on I-40, Take exit 53-B onto I-240 West towards downtown Asheville. As you cross the "French Broad River Bridge" merge into the far right lane, marked as an "Exit Only" for Exit 3-B (labeled Westgate and Resort Dr). Merge into the right lane as you pass the Westgate Shopping Center, Crown Plaza driveway is IMMEDIATELY as you round the curve to your right.

FROM THE WEST (Knoxville) Travel East on I-40, Follow signs for I-240 East towards Asheville (left exit), Merge into the left lane and take exit 3A. This will merge you onto Patton Ave., At the 2nd light make a right onto Regent Park Blvd (between Denny's and Pizza Hut), The road will bear right and our entrance will be immediately on the left (before entering Sam's Club parking lot), Follow the road past the golf course to the main entrance

FROM THE NORTH (Johnson City, TN): Travel South on Hwy 19/23 (also known as I-26 East) Merge onto I-240 West, Stay in the right lane as you merge, marked as an "Exit Only" for Exit 3-B (labeled Westgate and Resort Dr), Merge into the right lane as you pass the Westgate Shopping Center, Crown Plaza driveway is IMMEDIATELY as you round the curve to your right. **FROM THE SOUTH** (Asheville Regional Airport, Greenville/Spartanburg) Travel West on I-26, Follow signs for I-240 to Asheville, Merge into the left lane and take exit 3 This will merge you onto Patton Ave. At the 2nd light make a right onto Regent Park Blvd (between Denny's and Pizza Hut) The road will bear right and our entrance will be immediately on the left (before entering Sam's Club parking lot) Follow the road past the golf course to the main entrance.

HOTEL DOG SHOW GUIDELINES

Note: The Crowne Plaza hosts other dog show guests. Violation could result in a Bench Show Committee hearing. Guests must follow the rules below.

- A maximum of four (4) dogs allowed per room.
- Guests will be charged a one-time non-refundable dog fee of \$50.00 per stay. This fee applies to all guests with dogs.
- Dogs left unattended in a guest room must be in a crate. Plastic sheeting must be placed under each crate in the guest room area.
- Owners/exhibitors should bring their own towel for bathing the dogs. A daily inventory for missing or damaged towels will be taken. Any necessary charges will be applied to the guest.
- Bathing and/or grooming of dogs in or right outside the guest room is not allowed. The hotel will impose a \$100 penalty to anyone found grooming in this manner. The hotel has a grooming facility on the grounds, which will be available for use. Grooming is not allowed on any sidewalks.
- The individual guest will be responsible for any damage to a guest room or any hotel property. This includes, but is not limited to, replacement costs for carpeting if odors or stains cannot be removed with traditional cleaning methods.
- Dogs are to be on leash at all times when out of the guest room.
- The hotel and the show committee will investigate any problem areas that are outlined above. Any guest not following the above guidelines will be asked to check out of the hotel without refund.
- Dogs are not allowed in the following public areas: the lobby, restaurant, lounge, Holidome, and the respective hallways to the areas listed.
- There will be a \$100 fee for any removal of guest room furniture. All furniture must remain in the room at all times.
- Extension cords are not allowed to be plugged in to rooms from a vehicle, trailer, or camper in the parking lot.

The following apply to the guest room reservation policies: Room Assignment is at the discretion of the hotel. Special requests, such as drive up rooms, will be granted on a first-come, first-serve basis. This basis is in reference to the date the room was reserved, not the date the guest arrives. Our hotel cannot guarantee any special request. We will, however try our best to meet your wishes.

★ NOTICE TO EXHIBITORS ★

DOGS MAY ARRIVE any time prior to their scheduled time of judging. **DOGS NOT REQUIRED** for further judging will be excused.

JUDGES WILL NOT WAIT FOR ANY DOG HOLDING UP A CLASS. Owners or agents alone are responsible for the presence of their dogs in the judging ring when their classes are called to be judged. The show-giving club and the superintendent have no obligation or responsibility for providing service through a public address system or stewards or runners for the purpose of calling or locating dogs that are not brought into the ring when required.

ALL DOGS PRESENT must be held on leash or confined to their crates except when being judged or when in the exercising ring.

CLASS CASH PRIZES will be paid in the ring to the person showing the dog. Claims for prize money must be made in the ring before the judging of that class is over, and the Show Secretary to be advised at once. The Show Secretary and Show-giving Club may disclaim any liability for cash prizes after the judging of the class is over.

To find out about any AKC event cancellations visit raudog.co/cancellations

Exhibitors should follow their veterinarians' recommendation to assure their dogs are free of internal and external parasites, any communicable diseases and have appropriate vaccinations.

Effective January 1, 2009 - Refund and Cash award checks are void after 180 days and will NOT be re-issued.

Superintendent and the show-giving Club disclaim any liability for cash prizes after the judging of the breed is over.

Parents will be responsible for the actions of their children and their conduct both inside and outside the conference center.

Ring 2 - Pilot & Pisagh

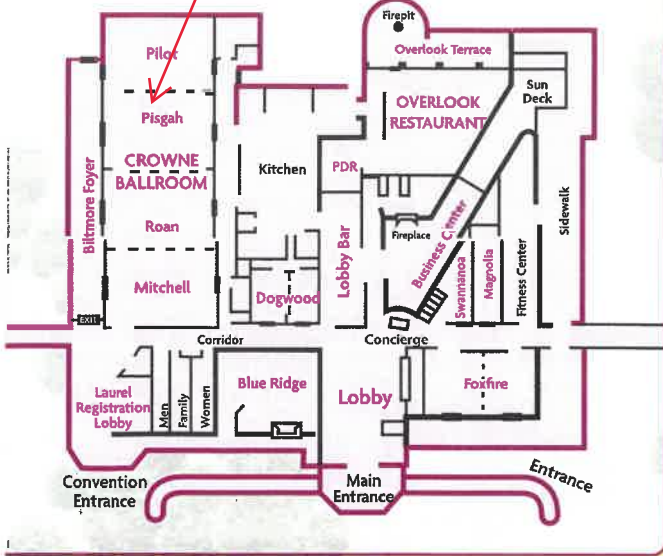

- Upper Villas**
1. Pisgah
 2. Mount Mitchell
 3. Pioneer
 4. Nolichucky
 5. Piedmont

- Lower Villas**
6. Appalachia
 7. Le Conte
 8. Cherokee
 9. Black Mountain
 10. Grandfather
 11. Blue Ridge
 12. Carolina
 13. Azalea
 14. Sugar Mountain
 15. Great Smokey
 16. Dogwood
 17. Laurelwood
 18. Swannanoa

Ring 1/Grooming
Expo Center Hours -
5:00 am - 10:00 pm
Expo Center will be
available after 10:00 am
Monday

